

ORME PARK

A Conceptual Master Plan

2 0 0 7

*A partnership between Friends of Orme Park, Starbucks Coffee &
Park Pride, Park Visioning Program*



A PARK VISIONING
PARTNER



park
pride

more & better parks... all over Atlanta

EXECUTIVE SUMMARY

The Orme Park Visioning Program began with the receipt of an application from the Friends of Orme Park, soliciting help organizing a Conceptual Master Plan for their neighborhood park. Once Park Pride accepted the application for Visioning, the neighborhood was invited to participate in the process.

The Steering Committee comprised the existing Friends of Orme Park group and met monthly to determine the direction of the public process and design outcome. The Committee distributed flyers and collected questionnaires during the annual Virginia Highlands festival, concentrating on Friday evening of the Summer Fest on June 1, 2007, where over 100 surveys were completed and gathered. The Steering Committee continued their diligence in promoting their first public meeting, the Visioning Meeting on Thursday, July 19th. At this meeting, participants were asked to imagine a world-class park in their neighborhood. A list of facilities and activities was developed and supplemented with the list begun from the surveys.

The second public meeting was on Thursday, August 16th at Hillside. The well-attended meeting gave participants the opportunity to fit the wish list onto the site. Five teams developed concepts that were presented to the other teams for comment and discussion. This led the Park Pride team on the mission of distilling those five plans into two preliminary conceptual master plans that were presented at September 20th's public meeting. Discussions about each option were held and the pros and cons of each were debated.

The Steering Committee met to discuss Park Pride's interpretation of the melding of the two plans. Edits were made and presented on Sunday, October 21st at the annual Orme Swarm, on the bridge anchoring the end of Orme Park. A prioritization exercise was done where participants were asked to draw green marks on the plan to denote which projects they would most like to see constructed first.

Park Pride compiled the project list. The Steering Committee reviewed the results of the prioritization exercise and determined which projects they considered to be the first tier priority projects and which they considered to be second tier. Since there is no funding available at this time for capital improvements in the park, funding opportunities may help serve as priorities for implementation.

The plan included herein is meant to serve as a documentation of the community's agreed projects and priorities for Orme Park. The Visioning plan illustrates concepts and is not considered to be a set of construction documents. It will take cooperation from the City, the neighbors, and the greater Atlanta community to construct all the changes in the park. The Steering Committee will serve an ongoing role in spearheading the changes to the park, finding funding sources, and overseeing project development. Park Pride will continue to serve as a liaison between the community and potential funding sources, including the City of Atlanta. It is expected that the entire build-out of the improvements proposed for Orme Park will take years, if not decades to complete. The first step, determining the best ways to improve Orme Park is completed and another chapter in its redevelopment can begin.



ORME PARK VISIONING PLAN

CONCEPTUAL MASTER PLAN

A partnership between Friends of Orme Park, Starbucks Coffee & Park Pride, Park Visioning Program



Project Key

- A* Restore/Enhance Bridge on Brookridge Drive
- B Western Entrance
- C Soft-Surface Path to Bridge
- D Stream Bank Buffer Plantings
- E Paved Path System
- F Northern Entrance
- G* Picnic Area at Playground
- H* Relocate, Expand and Update Existing Playground
- I Interpretive Signage
- J No Parking on Park-Side of Streets
- K New Bridge over Creek
- L Pedestrian 'Plaza' at Bridge/Playground
- M Cross-Park Lighting
- N Drinking Fountain
- O Buffer Plantings
- P* Renovate Existing Pedestrian Entrance/Signage
- Q Free-Play Lawn
- R Stream Bank Buffer Plantings
- S Boardwalk
- T Perimeter Lighting
- U Soft-Surface Path along Brookridge/Lawn
- V Buffer Plantings along Brookridge
- W Handicap/Stroller Entrance from Brookridge Drive

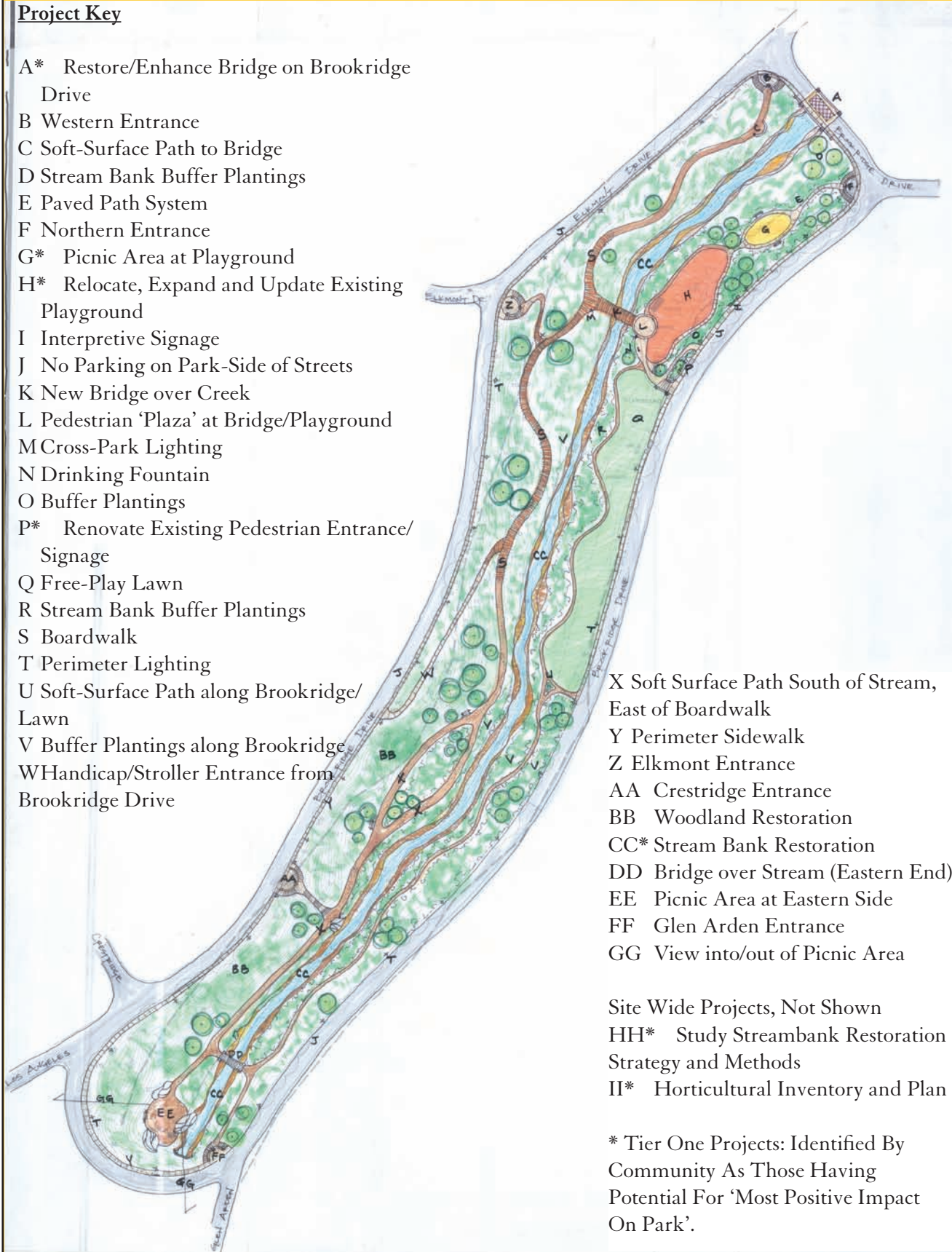

- X Soft Surface Path South of Stream, East of Boardwalk
- Y Perimeter Sidewalk
- Z Elkmoor Entrance
- AA Crestridge Entrance
- BB Woodland Restoration
- CC* Stream Bank Restoration
- DD Bridge over Stream (Eastern End)
- EE Picnic Area at Eastern Side
- FF Glen Arden Entrance
- GG View into/out of Picnic Area

- Site Wide Projects, Not Shown
- HH* Study Streambank Restoration Strategy and Methods
- II* Horticultural Inventory and Plan

* Tier One Projects: Identified By Community As Those Having Potential For 'Most Positive Impact On Park'.



VISIONING PLAN

conceptual final master plan: priorities

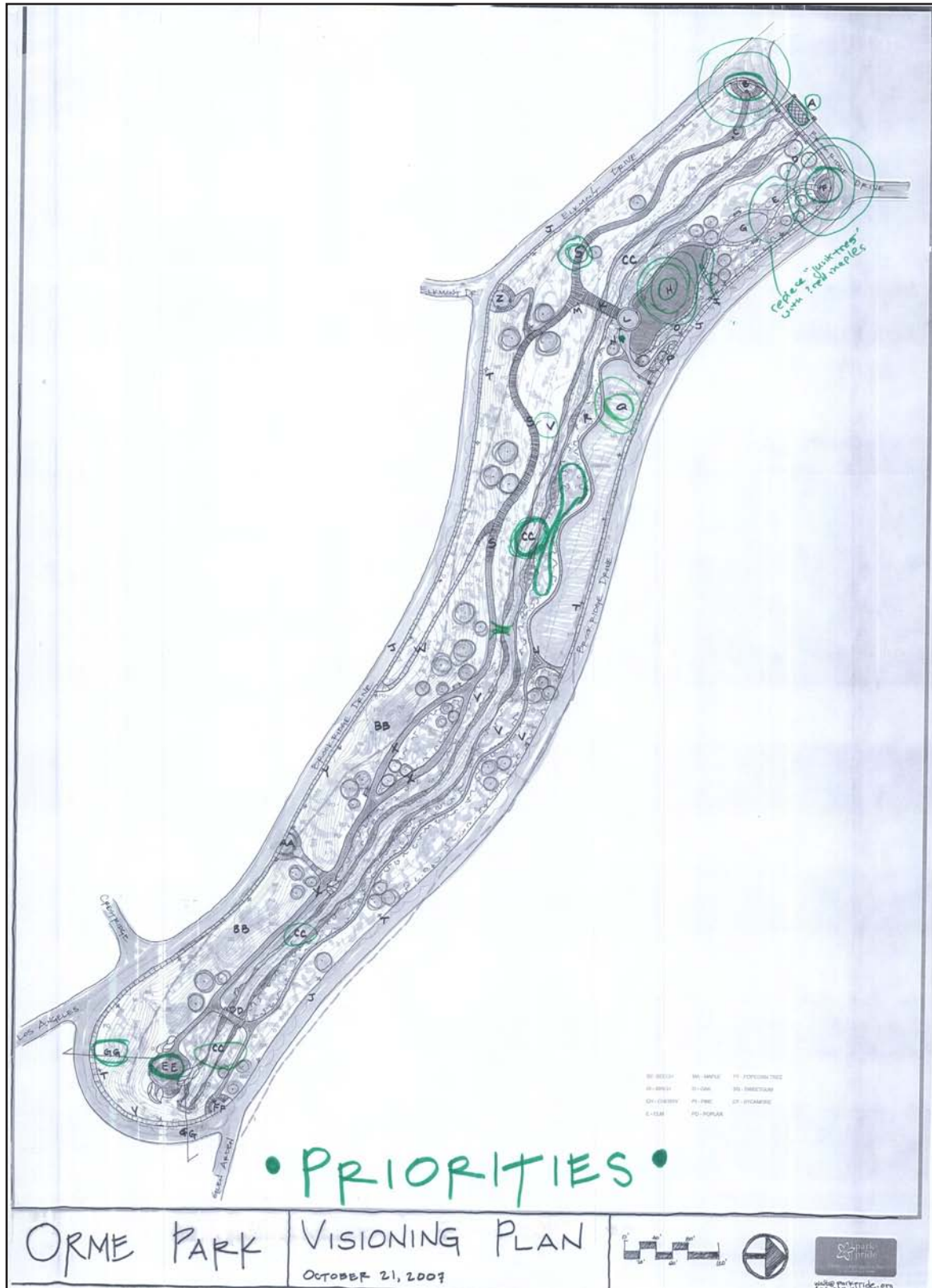

ORME PARK VISIONING PLAN: PROJECT LIST, OCTOBER, 2007				
KEY	ITEM	QUANTITY / DESCRIPTION	COST	PROJECT PRIORITY/FUNDING
A	Restore/Enhance Bridge on Brookridge Drive	Clean, restore, and enhance the bridge. Replace asphalt surface with brick paving at street-level. Add historically-appropriate lighting at street-level. Add lighting under bridge to enhance view from park and to discourage graffiti. Consider adding interpretive signage describing history of bridge and neighborhood.	\$300,000	TIER I PRIORITY
B	Western Entrance	Dual, circular, stone steps leading from street-level down to path level. Add lighting, park signage, and interpretive/directional signage.	\$60,000	
C	Soft-Surface Path to Bridge	Connect western entrance and existing/new bridge with soft surface path, 8'-10' in width. Provide overlook to restored bridge and stream. Surface should be native dirt, gravel, or mulch. Define edge of path to prevent widening of path over time. Consider adding decorative fencing to maintain plantings at edges of path.	\$10,000	Possible Volunteer Project
D	Stream Bank Buffer Plantings	Enhance existing buffer plantings along stream. Special consideration needs to be given to contouring earth and choosing plantings that are native and will minimize erosion.	\$10,000	TIER II PRIORITY - Potential Community Volunteer Project
E	Paved Path System	At northwest corner of Orme Park, provide 5'-7' wide paved paths from northern entrance, around picnic area and playground, to renovated existing pedestrian entrance (Item L).	\$25,000	
F	Northern Entrance	Dual, circular, stone steps leading from street-level down to path level. Add lighting, park signage, and interpretive/directional signage.	\$60,000	
G	Picnic Area at Playground	Small, soft-surface area (mini slate chip or wood chip) with three to four picnic tables. Add bench swings at each side of picnic area. Provide steel (Victor Stanley or equivalent) in area (not next to swings).	\$20,000	TIER I PRIORITY - Could be Community Volunteer Project
H	Relocate, Expand and Update Existing Playground	Relocate any existing equipment, especially the tall swing sets, and mix with additional play equipment to west side of existing entrance, in shady lawn. Replace lawn with playground mulch. Use new sidewalk as border for mulch, with a possible step down into playground to keep mulch off walk. Add bench swings along perimeter for adults	\$120,000	
I	Interpretive Signage	Provide interpretive signage describing history of neighborhood, development of park, renovation of park, and how the park is to be used while appreciating the native plant species, wildlife, and park amenities. Also, include sponsor acknowledgements, contact information, and upcoming community events.	\$45,000	
J	No Parking on Park-Side of Streets	Post no-parking signs along park side of all surrounding streets.	\$2,500	Community Lobbying City Council to Approve and Public Works to Provide Signage
K	New Bridge over Creek	Replace existing bridge with new one, 8'-10' in width. Historic character to emulate existing bridge to be restored (Item A). Add low-level lighting to enhance character and to provide security.	\$125,000	
L	Pedestrian 'Plaza' at Bridge/Playground	Small, hard surface area at north side of bridge. Perhaps 15' in width for people to gather while allowing circulation across bridge. Provide integral seating along perimeter and trash receptacle	\$18,000	
M	Cross-Park Lighting	Provide low-level lighting along path that bisects park (from north to south) between Item P and Item Z.	55,000	
N	Drinking Fountain	Provide cast-iron drinking fountain with dog-level bowl. Historic in character.	\$6,500	
O	Buffer Plantings	Enhance existing buffer plantings along stream. Special consideration needs to be given to contouring earth and choosing plantings that are native and will minimize erosion.	\$30,000	Possible Volunteer Project
P	Renovate Existing Pedestrian Entrance/Signage	Enhance existing pedestrian entrance with stone steps with flanking walls, signage, and historic lighting. Provide water-wise plantings with annual flowers planted twice yearly. Incorporate existing park sign with stone-work. Add	\$65,000	TIER I PRIORITY
Q	Free-Play Lawn	Once playground is relocated, renovate lawn between sidewalk and stream. Border lawn with narrow, soft-surface path that defines lawn from stream buffer plantings.	\$18,000	





KEY	ITEM	QUANTITY / DESCRIPTION	COST	PROJECT PRIORITY/FUNDING
R	Stream Bank Buffer Plantings	Enhance existing buffer plantings along stream. Special consideration needs to be given to contouring earth and choosing plantings that are native and will minimize erosion.	10,000	TIER II PRIORITY - Potential Community Volunteer Project
S	Boardwalk	Construct boardwalk above flood elevation, at new bridge level. Boardwalk should be approximately 10' wide. Wooden railings can have interpretive signage describing wildlife that lives in park.	\$350,000	TIER II PRIORITY
T	Perimeter Lighting	Add street-level lighting around perimeter of park. Lighting should be black, iron (or steel) decorative posts that are historically appropriate to era of neighborhood.	\$175,000	
U	Soft-Surface Path along Brookridge/Lawn	Connect Item P to Item FF (Glen Arden entrance) with soft-surface path. Surface should be native dirt, gravel, or mulch. Define edge of path to prevent widening of path over time. Consider adding decorative fencing to maintain plantings at edges of path.	\$15,000	Possible Volunteer Project
V	Buffer Plantings along Brookridge	Enhance existing buffer plantings along stream. Special consideration needs to be given to contouring earth and choosing plantings that are native and will minimize erosion.	\$10,000	TIER II PRIORITY - Potential Community Volunteer Project
W	Handicap/Stroller Entrance from Brookridge Drive	Paved path leading from high side of Brookridge Drive down to boardwalk level. Provide railing. Utilize existing road bed (abandoned) and be sure that path is graded to fit ADA criteria.	\$150,000	
X	Soft Surface Path South of Stream, East of Boardwalk	Connect boardwalk to picnic area (Item EE) with soft-surface path. Surface should be native dirt, gravel, or mulch. Define edge of path to prevent widening of path over time. Consider adding decorative fencing to maintain plantings at edges of path.	\$15,000	
Y	Perimeter Sidewalk	Hard-surface, sidewalk, 5'-6' wide, from Glen Arden entrance (Item FF) to end of lawn, where soft-surface path enters park. Along Brookridge Drive, consider placing sidewalk in existing asphalted travel/parking lane. This would leave two, 11'-wide lanes (at a minimum) and provide area for sidewalk with a minimum (or no) disturbance to steep slopes and woods.	\$340,000	
Z	Elkmont Entrance	Dual, circular, stone steps leading from street-level down to path level. Add lighting, park signage, and interpretive/directional signage.	\$55,000	
AA	Crestridge Entrance	Dual, circular, stone steps leading from street-level down to path level. Add lighting, park signage, and interpretive/directional signage.	\$55,000	
BB	Woodland Restoration	Remove exotic species such as privet and eleagnus. Introduce native ground covers such as ferns, herbaceous perennials, woodland vines, and bulbs. Plant trees that will replace very old trees or those that are in decline. Maintain tree canopy and introduce understory trees. Maximize diversity in plant life to provide for a wide diversity of animal and bird species.	\$55,000	Possible Volunteer Project - Apply for Park Pride's Tree Grant (to purchase trees)
CC	Stream Bank Restoration	To be engineered. Will include bank grading, stabilization, stones for water ripples (aeration of water), scour pools, and planting banks with native species to mitigate sheet-flow while stabilizing banks. Provide one to two areas for people to get to stream on rocks.	\$350,000	TIER I PRIORITY
DD	Bridge over Stream (Eastern End)	Replace existing bridge with new one, 8'-10' in width. Historic character to emulate existing bridge to be restored (Item A). Add low-level lighting to enhance character and to provide security.	\$65,000	
EE	Picnic Area at Eastern Side	Soft-surface area with picnic tables, trash receptacle, and bench swing. Add native plantings and stones for enhance beauty.	\$30,000	
FF	Glen Arden Entrance	Dual, circular, stone steps leading from street-level down to path level. Add lighting, park signage, and interpretive/directional signage.	\$55,000	
GG	View into/out of Picnic Area	Limb-up trees and clear tall shrubbery to provide better views into and out of Item EE. Replace lost shrubbery with low-growing native ground covers	\$6,000	Possible Volunteer Project
HH	Study - Stream Bank Restoration	Study the strategy and methods for a streambank restoration focusing on opportunistic improvements as changes in the park offer the chance to improve the stream bank without demolishing something that may currently be in the way (trees, pipes, etc).	\$40,000	TIER I PRIORITY
II	Study - Horticultural Inventory and Plan	Study the existing native and invasive species, document existing trees, and develop a plan to protect the tree canopy while enhancing the diversity of native species in the park and mitigate (or eradicate) invasive species.	\$30,000	TIER I PRIORITY
Orme Park Total:			\$2,776,000	