

Collier Heights Park

Conceptual
Master Plan

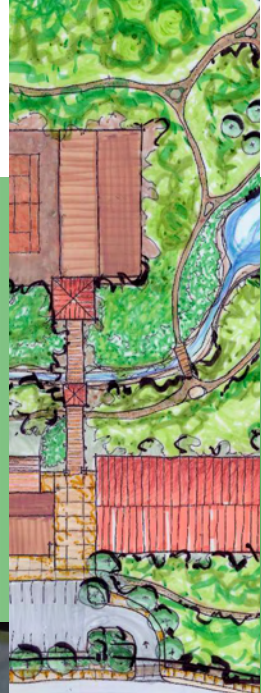

2006





KEY

- A – Small Pavilion 1 (12'x18')
- B – Small Pavilion 2 (12'x18')
- C – Small Pavilion 3 (12'x18')
- D – Landscape Pavilion Forest
- E – Existing Pavilion
- F – Existing Life Trail
- G – Pavilion Sidewalk
- H – Parents' Pavilion
- I – Playground Canopy
- J – Additional Playground
- K – Splash Pad
- L – Sidewalk Railing
- M – Streambank Restoration
- N – Driveway Realignment
- O – Nature Trail
- P – Road Frontage Landscaping
- Q – Rec. Center Update
- R – Landscape Rec. Center / Park Entrance
- S – Bridge To Sports Courts
- T – Gym
- U – Woodland Restoration
- V – Exercise System
- W – Wetland Restoration
- X – Interpretive Area
- Y – Bicycle/Pedestrian Trail To Fairburn Trail
Neighbors
- Z – Basketball Courts
- AA – Tennis Courts (Resurface)
- BB – Utility Screening
- CC – Sport Field Renovation
- DD – Baseball Field Renovation
- EE – Pedestrian Circle
- FF – Bull Pen
- GG – Bleachers
- HH – Public Restrooms
- II – Concessions/Press Box
- JJ – Bolton Road Entrance
- KK – Bolton Road Sidewalks
- LL – Soft Surface Trail Construction
- MM – Signage
- NN – Site Lighting (Pedestrian Scale)
- OO – Site Furnishings

COLLIER HEIGHTS PARK FINAL MASTER PLAN



NORTH
NOT TO SCALE
AUGUST 22, 2006

Collier Heights Park: Project List, October 17 2006

Priority	Item	Key on Master Plan	Approx. Cost	Description
Top Priority Project				
	Bull Pen	FF	\$30,000.00	
	Bleachers	GG	\$60,000.00	
	Public Restrooms	HH	\$0.00	Build with Concessions and Press Box
	Concessions/Press Box	II	\$120,000.00	
Second Priority Project				
	Bridge to Sports Courts	S	\$31,000.00	Landmark Bridge with simple, architectural, distinctive details
	Gym	T	\$950,000.00	House full-court basketball and event storage space. Built into the woods, avoid stream set-back. Large windows providing views into the surrounding woods. Gym to connect to existing Recreation Center through proposed breezeway that also provides access to sport court area (existing tennins and covered basketball)
Third Priority Project				
	Splash Pad	K	\$300,000.00	Themed to look like the source of the stream, but on separate water system.
Fourth Priority Project				
	Pavilion Sidewalk	G	\$6,000.00	Concrete sidewalk to connect the three new pavilions into the existing sidewalk system. Should be approximately 200 linear feet and 5' wide, avoid existing trees.
	Pedestrian Circle	EE	\$25,000.00	Remove some of existing walk to allow for pedestrian circle. Will serve to simplify flow of pedestrian traffic and create a visual node of interest in the park. Specimen plantings or sculptural element should go in center of raised seat wall/planter in center of circle. Paving should be concrete with granite accents.
Fifth Priority Project				
	Small Pavilion 1	A	\$30,000.00	Covered Pavilion to match existing. 12'x18', Two Picnic Tables, Concrete Pad.
	Small Pavilion 2	B	\$30,000.00	Covered Pavilion to match existing. 12'x18', Two Picnic Tables, Concrete Pad.
	Small Pavilion 3	C	\$30,000.00	Covered Pavilion to match existing. 12'x18', Two Picnic Tables, Concrete Pad.

Collier Heights Park: Project List, October 17 2006

High Priority Projects

Additional Playground	J	\$120,000.00	Aimed to provide additional play equipment to older children. The sloped area must be considered, since catalogue equipment is often designed for strictly flat parcels. Perhaps use sliding boards to utilize the existing slope along with an obstacle course. Locate swings on top of the slope once the drainage issue resolved. Maintain the existing trees to avoid having to provide shade at a later date.
Site Lighting	NN	\$250,000.00	Pedestrian scale lighting, black steel posts, unique style. Bright lighting in meadows and dim , ground level lighting in woodland. Motion sensor lights at gateways.
Soft Surface Trail Construction	LL	\$45,000.00	5' wide crusher run trail with pine straw top dressing. Minimal grading
Nature Trail	O	\$60,000.00	Soft-Surface (Crusher Run with Pine Straw Cover) Trail System. Minimal grading, 4'-6' wide
Existing Pavilion	E	\$5,000.00	Add electrical outlets, pave area between pavilion and grill with stone or brick
Sidewalk Railing	L	\$10,000.00	100 L.F. of metal railing along existing sidewalks
Existing Life Trail	F	\$0.00	Remain as is
Parent's Pavilion	HH	\$40,000.00	Locate between both playgrounds and splash pad. Allow room for strollers, parents, etc. Consider providing wireless internet access, and tensile playstructure to coordinate with Playground Canopy (Item I)
Playground Canopy	I	\$100,000.00	Provide shade in children's playground, consider tensile structure, possibly themed after a circus tent.
Landscape Pavilion Forest	D	\$15,000.00	Shrubs and evergreen groundcovers to soften the pine straw. Add flowering understory trees such as Dogwood and Redbud for visual impact, color and variety.

Collier Heights Park: Project List, October 17 2006

Medium Priority Projects

Streambank Restoration	M	\$65,000.00	Gently slope stream banks, add curves, rocks to form small pools, falls, enhance wildlife habitat and visual interest.
Driveway Realignment	N	\$45,000.00	Add exit path, make driveway one-way in and one-way out (see plans), to eliminate traffic conflicts
Road Frontage Landscaping	P	\$40,000.00	Lush landscaping along Collier Drive, use flowering evergreen shrubs and groundcovers
Woodland Restoration	U	\$10,000.00	Remove invasive species (Privet and Kudzu), introduce natives (check with GA Native Plant Society, Plant Rescue Program) Mostly volunteer efforts.
Exercise System	V	\$65,000.00	Exercise stations along woodland paths, higher difficulty level than Life Trail.
Wetland Restoration	W	\$65,000.00	Remove gravel from previous wetland, dredge area, re-introduce native wetland plant species
Interpretive Area	X	\$65,000.00	Deck over wetland, with interpretive signage about native wetland flora and fauna and process of restoring wetlands and the ecological benefits of doing so.
Bicycle / Pedestrian Trail to Fairburn Trail Neighborhood	Y	\$350,000.00	Will need to include atleast 2 short bridges, and a few culverts, minimum grading required. Cover gravel base with asphalt along main route to park. Side trails can be crusher run with pine-straw top dressing.
Landscape Rec Center / Park Entrance	R	\$15,000.00	Foundation planting in evergreen shrubs, small trees and ground covers, annual color near front door.
Utility Screening	BB	\$10,000.00	Disguise utility area with lattice, roof as if it is a gazebo, and evergreen planting
Bolton Road Entrance	JJ	\$65,000.00	Minimal parking spaces, sidewalk, landscape plantings, signage
Bolton Road Sidewalks	KK	\$110,000.00	5 ' wide concrete walks along Bolton Road
Signage	MM	\$15,000.00	Add signage regarding park rules, park name and interpretive signage along paths. Should be all of similar family and outdoor quality construction. Consider linking visually to new Park Department signs.
Site Furnishings	OO	\$40,000.00	Steel, painted black, consider Victor Stanley products.
Projects already in progress			
Rec Center Update	Q	\$0.00	In progress
Basketball Courts	Z	\$0.00	Resurface and maintain
Tennis Courts	AA	\$0.00	Resurface and maintain
Sport Field Renovation	CC	\$0.00	In progress
Baseball Field Renovation	DD	\$0.00	In progress
TOTAL		\$3,217,000.00	