

2 Concept



Sunken plaza with water feature to soften noise



New Entrance to Zoo Atlanta (planned)



Existing winding pedestrian path with lighting



Children's Holocaust Memorial Project



Native grasses planted to protect slopes of Fort Walker



Slate chip trail through woodland with benches



HISTORIC SE QUADRANT
GRANT PARK, ATLANTA

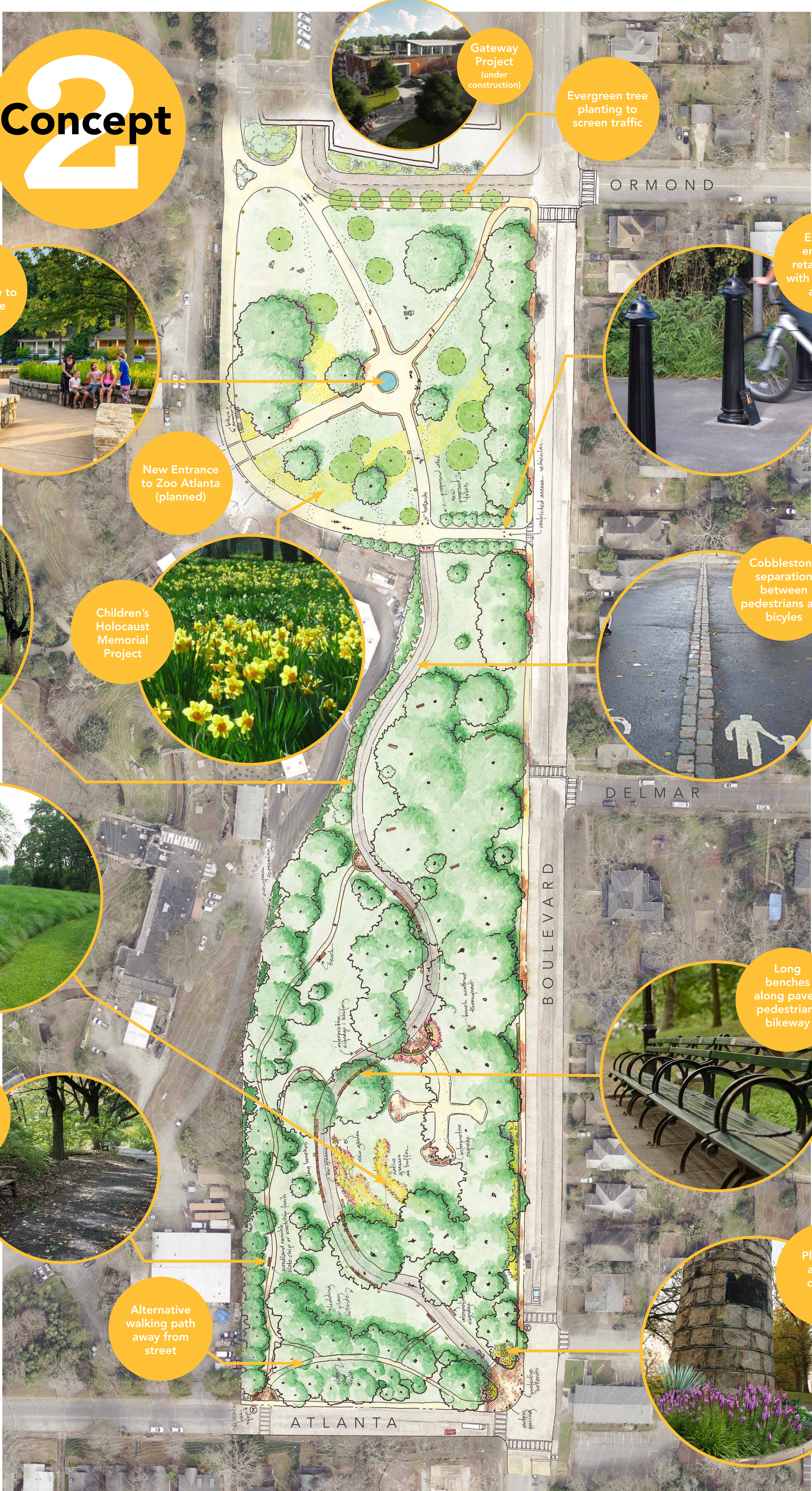

Gateway Project (under construction)

Evergreen tree planting to screen traffic



Existing entrance retained but with restricted access



Cobblestone separation between pedestrians and bicycles



Long benches along paved pedestrian/bikeway



Plantings around column bases