

2006



Spink - Collins Park Conceptual Master Plan

Park
Pride 



Executive Summary

Spink Collins Park

Spink Collins Park is located in the revitalizing and growing Collins Park neighborhood in west Atlanta. The neighborhood is very diverse in cultural, income, and educational levels. Still, there is a tight-knit community forming with an active citizenry. The park parallels Spink Street on the upper end and Collins Drive dead-ends into the park at an unfinished bridge that connects the park entrance to the neighborhood.

The 21 acre park is heavily wooded with a stream running through it. Invasive species are well-established in the lower-lying areas but the higher ground is rich in a variety of native plant species. There are existing ruins of old stone buildings, steps, and walls on the property. The park land was donated, but never developed. There was a period of time when it was unclear if the land was a public park or was privately owned. Recently, that was clarified and neighbors have been actively trying to make the land usable as a park. Community members have worked very hard to remove truckloads of illegally-disposed-of tires, cut pedestrian paths through the thick privet, uncovered vegetation and debris off the existing ruins, built picnic tables, installed plant identification (interpretive) signs, and regularly schedule volunteer days to keep the park looking clean and tidy.

The Kick-Off meeting was July 26, 2006. The Committee met monthly from then until March 10, 2007. During that time, neighborhood surveys were conducted, four public meetings were widely advertised and held, and the final plans were developed. The Steering Committee has sought and received Neighborhood Association approval and Neighborhood Planning Unit (NPU) approval. The Steering Committee is still strongly active in their park. More community members have become active, and the group is eager to implement parts of their conceptual master plan.

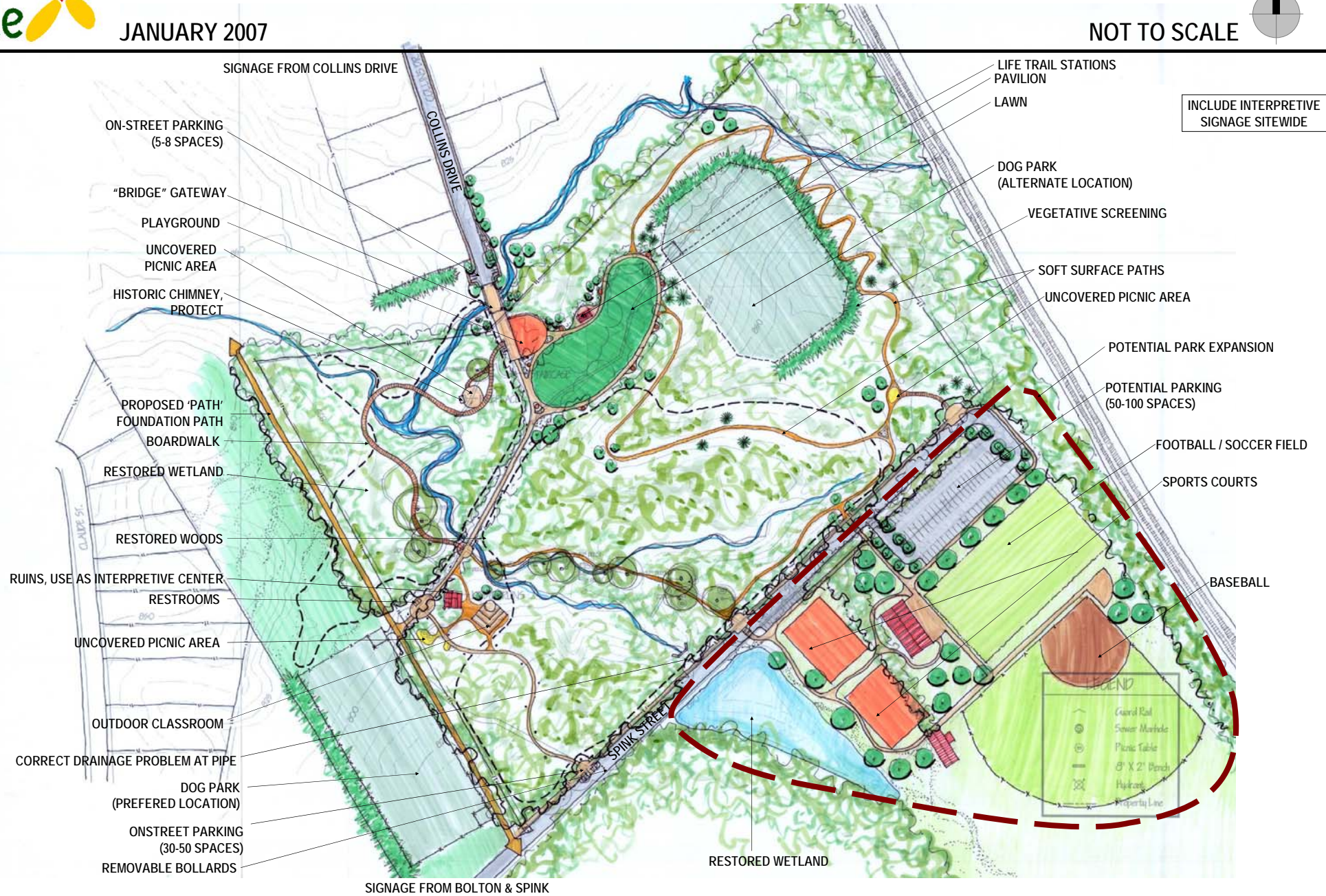

INCLUDE INTERPRETIVE SIGNAGE SITEWIDE

LEGEND

	Guard Rail
	Sewer Manhole
	Picnic Table
	8' X 2' Bench
	Hydrant
	Property Line

COLLINS PARK CONCEPTUAL MASTER PLAN: PROJECT LIST, JANUARY 2007

ITEM	QUANTITY / DESCRIPTION	COST
Dog-Park In GA Power Easement (2 Dots)	Needs Fencing, Gates, and Drinking Fountain for Both Humans and Dogs, Include Evergreen Screening Between Dog Park and Residential Structures	\$15,000.00
Bridge / Gateway Feature (3 Dots)	One Bridge, 'Gateway' Character	\$50,000.00
Paved Sidewalk from Gateway to PATH		\$30,000.00
Playground (2 Dots)	Includes Extensive Site Work, Leveling Site, Grading and Drainage	\$200,000.00
Lawn	Includes Clearing of Brush, Minimal Grading, Paved Walk Surrounding	\$20,000.00
Pavilion	Architectural Character, Stone and Timber Construction with Red Metal Roof, Approx. 16' x 24' on Flagstone Pad	\$45,000.00
Life Trail System		\$60,000.00
Lighting	Low Level Lighting Along Paved Paths	\$200,000.00
On-Street Parking (Off Collins Drive, 5-8 Spaces)	Includes Drainage Improvements	\$25,000.00
Soft Surface Paths (2 Dots)	Built Mostly with Volunteer Help, Gravel Base with Pine Straw Cover	\$30,000.00
Removable Bollards (2 Dots)	Spink Street, To Control Dumping of Trash and Limit Access down Dead-End Street	\$4,500.00
Outdoor Classroom (1 Dot)	Timber Benches with Wooden 'Stage' in Circular Pattern	\$5,000.00
Interpretive Signage	Site-Wide, Identify Flora and Fauna, Professionally Designed and Printed on Plastic, Resin, or Metal Signs	\$5,000.00
Directional Signage (From Neighborhood)		\$12,000.00
Paved Sidewalk from PATH to Spink	6' Wide	\$30,000.00
Ruins Used as Interpretive Center	Stabalize Walls, Add or Restore Masonry Floor, Add Metal Roof, Add Artifacts, Photos, Stories, Oral Histories of Boy Scout Cabin, Neighborhood, Region	\$60,000.00
Uncovered Picnic Area (at Remote Node)	Mulch Surface with Picnic Tables (already built by community)	\$500.00
Uncovered Picnic Area at Outdoor Classroom	Mulch Surface with Picnic Tables (already built by community)	\$500.00
On-Street Parking (Spink Street)	Restripe, Add Planting Islands, Sidewalk	\$45,000.00
Uncovered Picnic Area at Historic Chimney	Mulch Surface with Picnic Tables (already built by community)	\$500.00
Historic Chimney (Protect in Place)	Maintain and Stabilize	\$1,000.00
Restored Woodland	Remove Invasive Species, Volunteer and Professional Help, Introduce Native Species of Plants, Consider Teaming with Georgia Native Plant Society	\$10,000.00
Restored Wetlands	Remove Invasive Species, Volunteer and Professional Help, Introduce Native Species of Plants, Consider Teaming with Georgia Native Plant Society	\$10,000.00
Drainage Correction At Pipe (Sink-Hole Area)	Study Root Problem. Filling with New Soil is Ineffective. Pipe may Need to be Replaced	\$50,000.00
Stream Restoration	Add Rocks, Minimal Regrading, Plantings	\$50,000.00
Boardwalk	400 Linear Feet, Elevated Structure with Railings, Wood Flooring, Curvilinear Design	\$100,000.00
Restrooms	One-Stall per Gender, Will Need to Manned for Security, Maintenance, and Cleaning	\$35,000.00
Potential Park Expansion		
Potential Parking (50-100 Spaces)		\$75,000.00
Football / Soccer Field		\$50,000.00
Sports Courts		\$65,000.00
Baseball		\$100,000.00
Restore Wetlands		\$30,000.00
TOTAL		\$1,414,000.00
Alternate B: Dog Park (Within Park)		
Dog Park (Within Park)		\$15,000.00
Vegetative Screening Around Dog-Park Within Park		\$15,000.00
ADDITIONAL COST FOR ALTERNATE B		\$30,000.00